

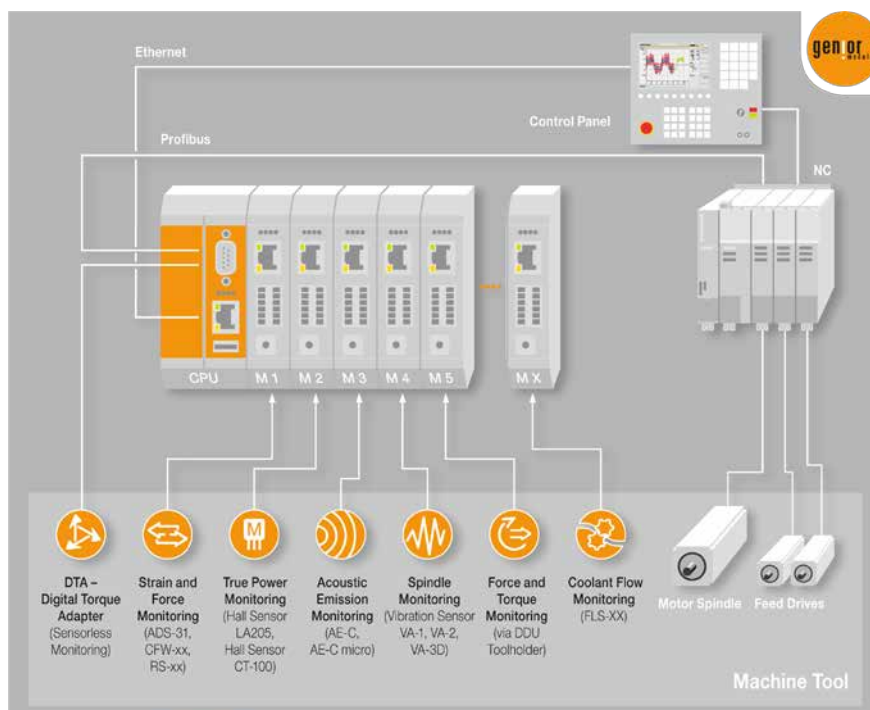

## Special Features

- Monitoring system for machine tools in serial production lines
- Supported interfaces: Profibus, Focas 2, Profinet, parallel wiring
- Monitors tool breakage, missing tools, tool wear, Adaptive Control (AC)
- Monitors up to 10 NC-channels
- Up to 8 additional sensors connectable
- Max. 24 signals
- Sample rate adjustable (min. 2 ms, typical 10 ms)

## TOOL & PROCESS MONITORING GENIOR MODULAR BASE MODULE



## Modular System

Genior Modular is a fully automatic system for process-monitoring and -control for machine tools in metal cutting.

Genior Modular captures the necessary measurement data digitally via the base module GEM CPU-02-DP/F. For special monitoring tasks, the system may also be operated with different sensors and corresponding measuring transducers.

### Measuring transducers for:

FM-01	Force, strain and coolant flow ± 10 V, 4...20 mA
TP-01	True power
AM-01	Acoustic emission
VM-01	Vibration and acceleration
VM-02	Vibration and acceleration, collision monitoring
TF-01	Torque and axial force
IO-01	Input/output converter

# Genior Modular Base Module

GEM CPU-02-DP/F

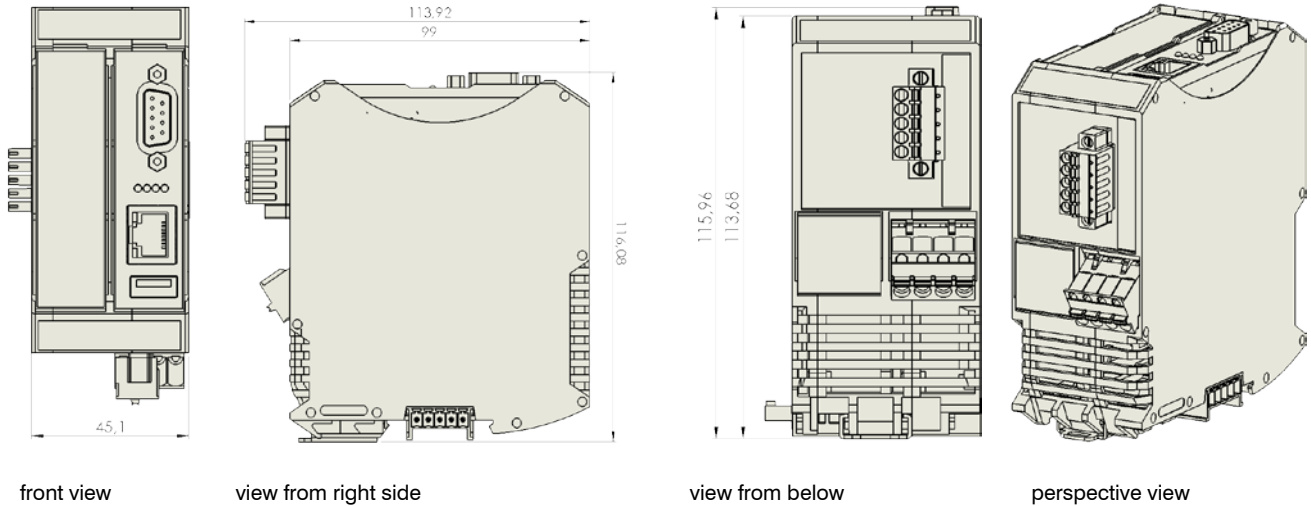

<b>O830Z510004</b>	
Dimensions	see drawing
Weight	243 g
Material	Polyamid PA 6.6
Storage temperature	-20 °C...+60 °C
Operating temperature	0 °C...+50 °C
Flammability class	VO (UL94)
Rel. humidity	5 – 85 % no condensation
Degree of protection	IP20
Contacting	Spring terminals, in-rail bus connector
Installation	Mounting rail acc. to DIN EN 60715
Voltage supply	24 V ±20 %
Nom. current consumption	max. 500 mA
Ripple	max. 5 %
Interfaces	2 x ARTIS CAN-Bus 10/100 Base T Ethernet USB Host Profibus up to 12 MBits/s
Control requirements	Profibus or Focas or Profinet or inputs/outputs for parallel wiring

Control types (examples)	Siemens 840D SL, Fanuc, Bosch-Rexroth etc.
Conformity	CE

<b>Licence codes for additional Genior Modular functions (order separately)</b>	
<b>GEM DTA-DP OCMZ5100004</b>	Licence code for activating the sensorless torque monitoring
<b>GEM C OCMZ5100005</b>	Licence code for activating one additional monitoring channel
<b>GEM F-AC OCMZ5100003</b>	Licence code for activating the Adaptive Control AC
<b>GEM F-WEAR OCMZ5100002</b>	Licence code for activating the wear monitoring

<b>Supported components</b>	
Cable Ethernet (CO) (Code see cable lengths)	Connection cable (crossover) 2 m: Code O6739797065 5 m: Code O6739797066 10 m: Code O6739797067 20 m: Code O6739797068

For a full list of address locations, please consult the Marposs official website

ODN6421EN02 – Edition 01/2018 – Specifications are subject to modifications  
© Copyright 2018 MARPOSS Monitoring Solutions GmbH (Germany) – All rights reserved.



www.marposs.com

ARTIS and Marposs product names/signs mentioned or shown herein are registered trademarks or trademarks of Marposs in the United States and other countries. The rights, if any, of third parties on trademarks or registered trademarks mentioned in the present publication are acknowledged to the respective owners.

Marposs has an integrated system to manage the Company quality, the environment and safety, attested by ISO 9001, ISO 14001 and OHSAS 18001 certifications. Marposs has further been qualified EAQF 94 and has obtained the Q1 Award.



Download the latest version of this document